

Section A

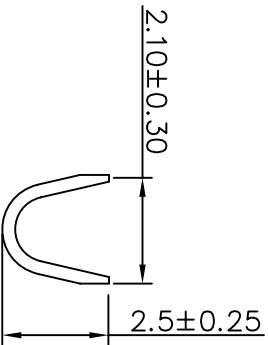

Section B

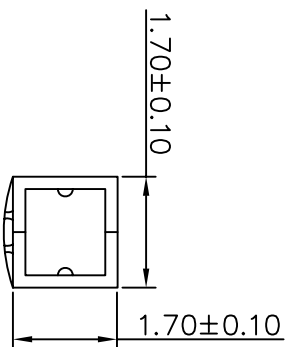

Section C

SPECIFICATION

Voltage rating: AC, DC 250V

Current rating: AC, DC, 7A

Withstand voltage: 1500V AC/min.

Insulation resistance: 1000M Ω /min.

Temperature range: $-25^{\circ}\text{C} \sim +85^{\circ}\text{C}$

Applicable wires: AWG#24~18

Material: Brass.

Finish: Tin plated

Thickness: 0.2mm

TOLERANCE TABLE

.0	± 0.20
.00	± 0.10
.000	± 0.05

APPROVED:	DATE:	 深圳市矽科盟实业有限公司 CHANKLEMENT INDUSTRY CO., LTD	TITLE:						
CHECKED:	DATE:		55571S (母端子)						
DRAWN:	DATE:	CLIENT P/N	/	UNIT	mm	SCALE	free	REV.	A
L.Y.F	2008-04-07	FILE NO.	Ckmtw-5557-0003						